

## Pietranera Shark Shampoo System



All dimensions are in centimeters/millimeters

# Pietranera Shark Shampoo System

322



ART. 506/F1

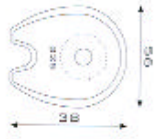

ART. 506/F1  
ART. 56L/1B

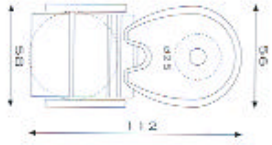

ART. 507/F1  
ART. 66L/4B

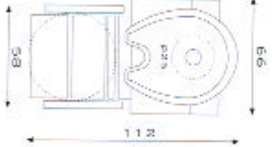

ART. 507/F1

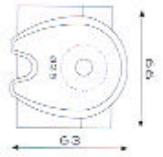

ART. 507/F1 N°2  
ART. 66L/2B

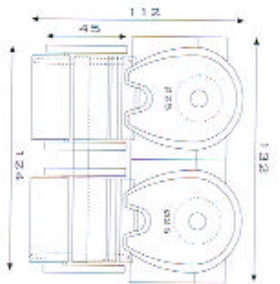

ART. 507/F1 N°3  
ART. 66L/3B

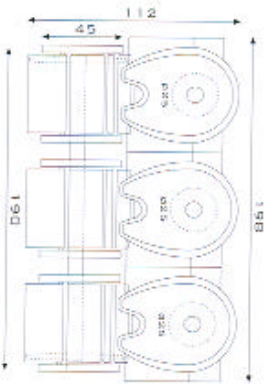

S H A R K

# Pietranera Shark Shampoo System

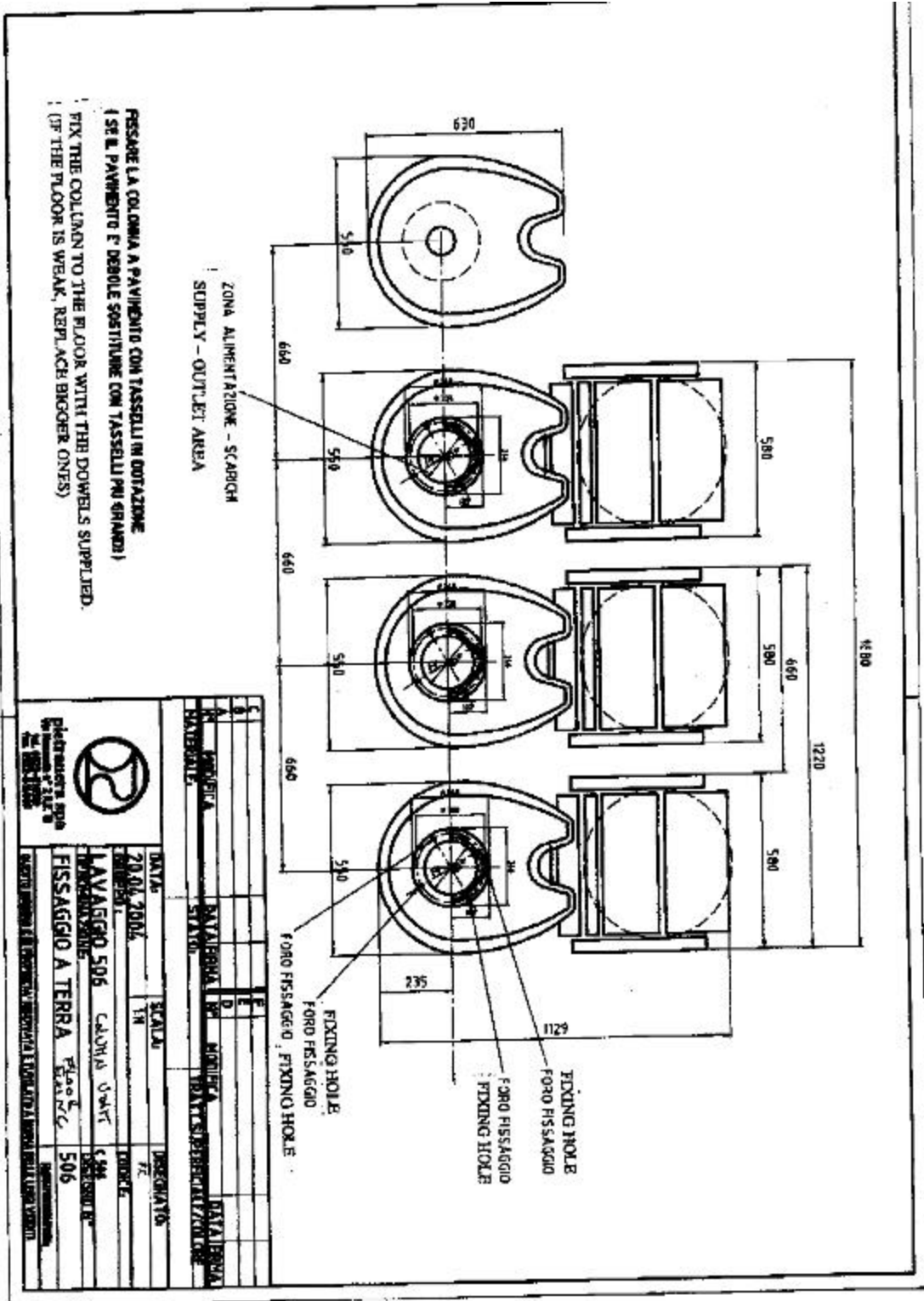

PESSARE LA COLUMNA A PAVIMENTO CON TASSELLI IN DOTAZIONE  
 (SE IL PAVIMENTO È DEBOLE SOSTITUIRE CON TASSELLI PIÙ GRANDI)  
 FIX THE COLUMN TO THE FLOOR WITH THE DOWELS SUPPLIED.  
 (IF THE FLOOR IS WEAK, REPLACE BIGGER ONES)

		<b>PIETRANERA SPA</b> Via S. Maria 10 00187 ROMA	
<b>AVVERTENZE</b> LEGGERE LE AVVERTENZE E ISTRUZIONI IN DOTAZIONE		<b>AVVERTENZE</b> LEGGERE LE AVVERTENZE E ISTRUZIONI IN DOTAZIONE	
<b>DATA:</b> 20.01.2006	<b>SCALE:</b> 1/1	<b>DESCRIZIONE:</b> LAVAGGIO 506	<b>PRODOTTORE:</b> CAONIA S.p.A.
<b>PRODOTTORE:</b> LAVAGGIO A TERRA	<b>PRODOTTORE:</b> CAONIA S.p.A.	<b>PRODOTTORE:</b> LAVAGGIO A TERRA	<b>PRODOTTORE:</b> CAONIA S.p.A.

# Pietranera Shark Shampoo System

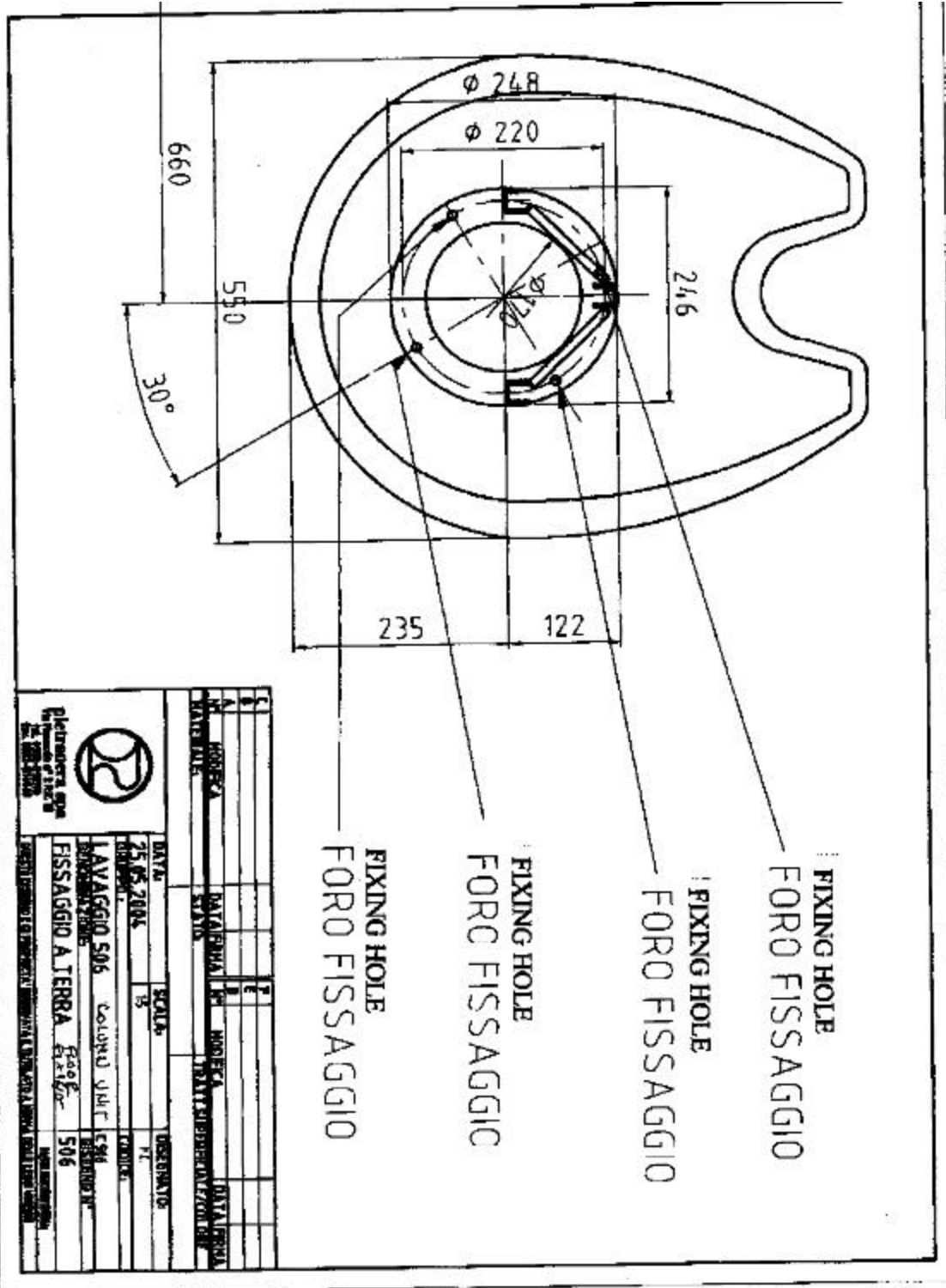

 Pietranera spa Via... 20138...		
DATA	SCALE	USCIBATO
25.05.2004	1:5	PT
LAVAGGIO 506	COLONN. VIT. C	ESSE
FISSAGGIO A TERRA	PROF.	506

